

FLOOR LEVEL	ELEVATION
LEVEL 17	+182'-8"

1 RESIDENTIAL CONDOMINIUM FLOOR PLAN - LEVEL 17
1/16"=1'-0"

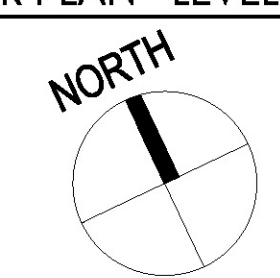

ARCHITECT:
THIS WORK WAS PREPARED BY ME
OR UNDER MY SUPERVISION AND
CONSTRUCTION OF THIS PROJECT
WILL BE UNDER MY OBSERVATION.

NOTE: CONTRACTOR SHALL CHECK
AND VERIFY ALL DIMENSIONS AT JOB
BEFORE PROCEEDING WITH WORK.

HAWAII OCEAN
PLAZA LP

Ala Moana Home
Honolulu, Hawaii
T.M.K. 2-3-016 : 018 / 019 / 020

IPD-T PERMIT
APPLICATION SET

DATE 2022 Apr 26

PROJECT # 22002

SHEET CONTENT:
OVERALL PLAN:
LEVEL 17

SHEET NO.
A1-1.11

FLOOR LEVEL	ELEVATION
LEVEL 40	+395'-9"
LEVEL 39	+386'-2"
LEVEL 38	+376'-11"
LEVEL 37	+367'-8"
LEVEL 36	+358'-5"
LEVEL 35	+349'-2"
LEVEL 34	+339'-11"
LEVEL 33	+330'-8"
LEVEL 32	+321'-5"
LEVEL 31	+312'-2"
LEVEL 30	+302'-11"
LEVEL 29	+293'-8"
LEVEL 28	+284'-5"
LEVEL 27	+275'-2"
LEVEL 26	+265'-11"
LEVEL 25	+256'-8"
LEVEL 24	+247'-5"
LEVEL 23	+238'-2"
LEVEL 22	+228'-11"
LEVEL 21	+219'-8"
LEVEL 20	+210'-5"
LEVEL 19	+201'-2"
LEVEL 18	+191'-11"
LEVEL 17	+182'-8"

REF. PREV. SHEET

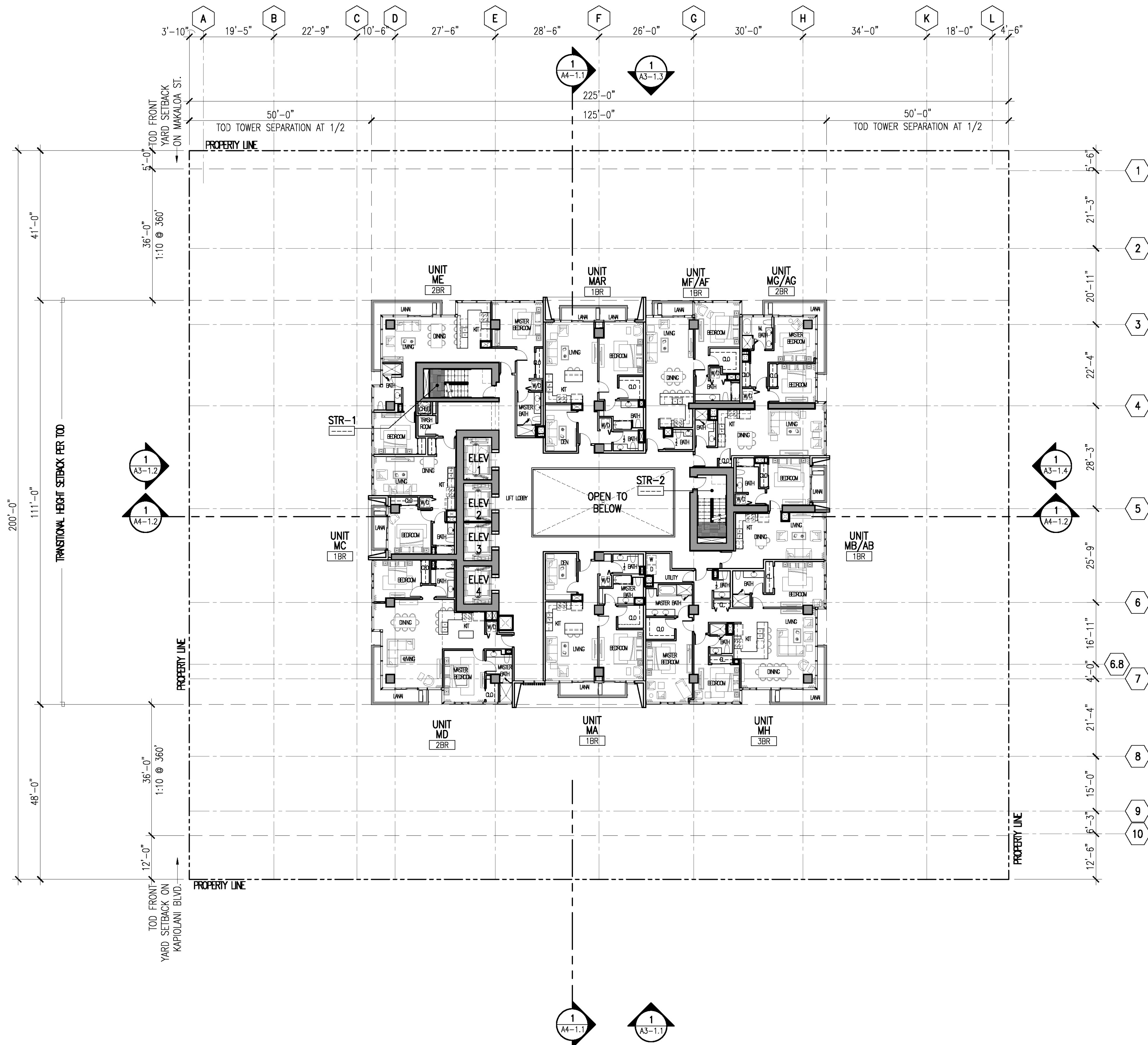

FLOOR LEVEL	ELEVATION
LEVEL 40	+395'-9"
LEVEL 39	+386'-2"
LEVEL 38	+376'-11"
LEVEL 37	+367'-8"
LEVEL 36	+358'-5"
LEVEL 35	+349'-2"
LEVEL 34	+339'-11"
LEVEL 33	+330'-8"
LEVEL 32	+321'-5"
LEVEL 31	+312'-2"
LEVEL 30	+302'-11"
LEVEL 29	+293'-8"
LEVEL 28	+284'-5"
LEVEL 27	+275'-2"
LEVEL 26	+265'-11"
LEVEL 25	+256'-8"
LEVEL 24	+247'-5"
LEVEL 23	+238'-2"
LEVEL 22	+228'-11"
LEVEL 21	+219'-8"
LEVEL 20	+210'-5"
LEVEL 19	+201'-2"
LEVEL 18	+191'-11"
LEVEL 17	+182'-8"

REF. PREV. SHEET

1 RESIDENTIAL CONDOMINIUM FLOOR PLAN - LEVEL 18-40
1/16"=1'-0"

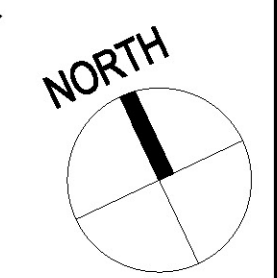

ARCHITECT:
THIS WORK WAS PREPARED BY ME
OR UNDER MY SUPERVISION AND
CONSTRUCTION OF THIS PROJECT
WILL BE UNDER MY OBSERVATION.

NOTE: CONTRACTOR SHALL CHECK
AND VERIFY ALL DIMENSIONS AT JOB
BEFORE PROCEEDING WITH WORK.

HAWAII OCEAN
PLAZA LP

Ala Moana Home
Honolulu, Hawaii
T.M.K. 2-3-016:018/019/020

IPD-T PERMIT
APPLICATION SET

DATE 2022 Apr 26

PROJECT # 22002

SHEET CONTENT:
RESIDENTIAL
CONDOMINIUM
FLOOR PLAN:
LEVEL 18-40

SHEET NO.
A1-1.12